

# Aquamox Insulation Board Installation Instructions

## Insulation Board

Lay in a Brick Pattern as per diagram.

The board can be cut with a Jigsaw or Stanley Knife.

Each sheet of Insulation Board measures 1200 x 600 x 6mm.

One sheet will cover approx 0.72 sq metres. Available in packs of 10.

A pack 10 of tiles covers 7.2 sq metres.

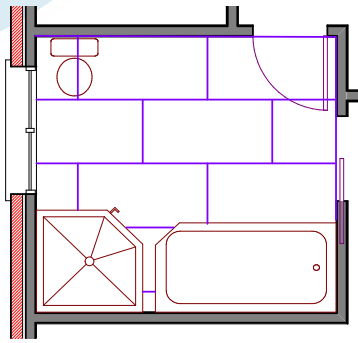

## Cross Section Detail

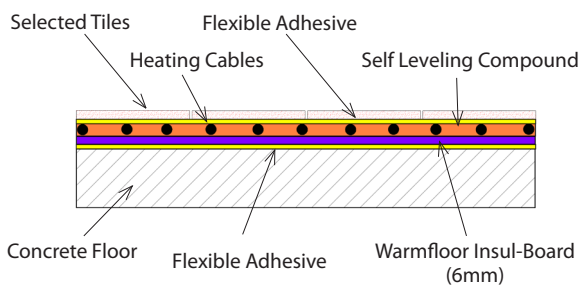

## Timber Floor

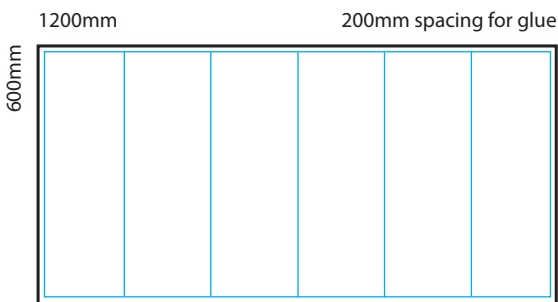

Screws 50mm from edging

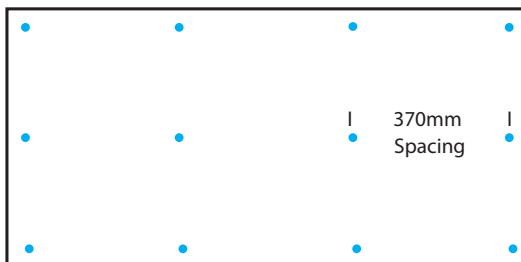

We recommend the Sika products and compliances below.

For all installations, Sika brand products are recommended.

- PRODUCTS:**
- Sika Primer 11 W +
  - Prohesive Promaxset Plus
  - Sikaflex® -123 MS Bond Adhesive
  - Sikafloor Level Pro

## 1 General

- 1.1 This technical specification is to be read in conjunction with the project Contract Documents and Specification.
- 1.2 All work to be carried out in accordance with the current Sika (NZ) Ltd data sheets.

## 2 Surface Preparation

- 2.1 All structural building components must comply with the New Zealand Building Code and relevant New Zealand standards including NZS 3604, NZS 3603, NZS 3403 and E2/AS1.
- 2.2 All concrete floors must have all contaminants removed and ground if necessary prior to priming.
- 2.3 All timber floors must have all contaminants removed and sanded if necessary prior to priming.
- 2.4 All dust, dirt and other contaminants must be removed before priming with Sika Primer 11 W +.

## 3 Priming

- 3.1 Substrates shall be primed with Sika Primer 11 W + strictly in accordance with the technical data sheet.

## 4 Application

- 4.1 Concrete / cementitious substrates. Apply Prohesive Promaxset Plus using a 6mm x 6mm notched trowel keeping the notched ridges running in one direction
- 4.2 Place Insulation board. The board should be pressed into wet adhesive and moved at least the width of the notch, perpendicular to the adhesive notch to ensure full adhesion.
- 4.3 Timber floors - Apply Sikaflex® -123 MS Bond Adhesive (or equivalent – must be non-solvent based) around the perimeter of Warmfloor insulation boards and at 200mm centres.
- 4.4 After applying the adhesive, fit Insulation boards to the timber floor. They must also be secured with screws that have 30mm countersunk washers, 12 screws per sheet. (screws and adhesive available from Warmfloor)

## 5 Installation

Install Warmfloor Heating cables as per manufacturers instructions.

### Levelling

- 5.1 Sikafloor Level Pro Is a one pack self-levelling mortar. Pour the product onto the substrate and spread with a flat trowel. Roll a spiked roller over the whole surface, before the product starts setting.
- 5.2 Once the Sika Level Pro is completely cured your floor is now ready for Tile Installation.

For more information, please call Warmfloor on  
**0800 492 763**  
or email [info@warmfloornz.com](mailto:info@warmfloornz.com)